

| REVISIONS |                 |      |          |
|-----------|-----------------|------|----------|
| LTR       | DESCRIPTION     | DATE | APPROVED |
| —         | INITIAL RELEASE |      | H D      |
|           |                 |      |          |
|           |                 |      |          |

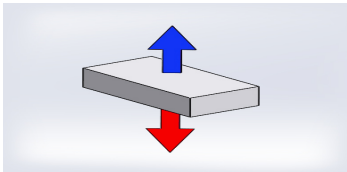
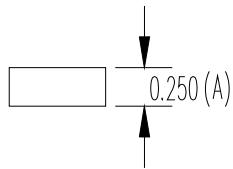
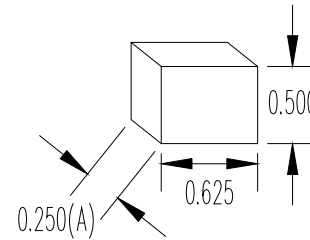
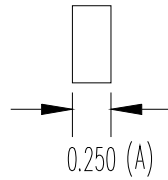
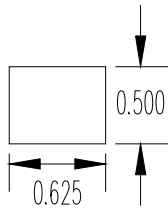

|  |               |
|--|---------------|
| UNLESS OTHERWISE SPECIFIED<br>DIMENSIONS ARE IN INCHES |               |
| TOLERANCES:  |               |
| FRACTIONS:   | $\pm 1/64$    |
| DECIMALS:  | $\pm 0.015$   |
| ANGLES:  | $\pm 1^\circ$ |
| MATERIAL:  | NdFeB         |
| FINISH:  | NiCuNi        |

|   |                 |                     |   |
|---|-----------------|---------------------|---|
| <b>RADIAL MAGNETS INC.</b>                          |                 |                     |   |
| 108B NW 20th St. BOCA RATON, FL 33431 (561)392-2103 |                 |                     |   |
| SHAPE<br>BLOCK                                      | STRENGTH<br>N35 | PLATING<br>NiCuNi   | SIZE AND DIRECTION OF MAGNETIZATION (A)<br>5/8" x 1/2" x 1/4" |
| SIZE<br>A   | PART #<br>8388  | DRAWING #<br>RM8388 | REVISION<br>-   |
| SCALE 1 : 1   | DRAWN: CG       | CHECKED: HD         | APPROVED: HD PAGE 1 OF 1                                      |